

Food Habitat Mapping

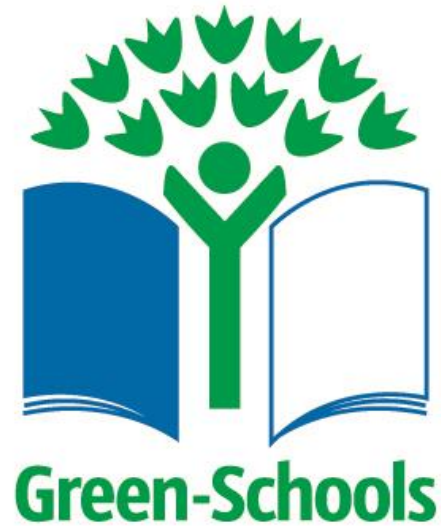

What is a Food Habitat Map?

A Food Habitat Map is a map which uses a “bird’s eye” view of the school to show everything related to food growing, storing and eating inside your school and on the grounds.



Why Make One?

- To show how many places are related to food in the school.
- To choose any areas that would be suitable for growing food.
- To find any problem areas with food litter, waste etc
- To find any wild food growing.
- Show areas related to wildlife and food.



What should we include?

Indoor:

- Areas selling, storing food
- Water fountains or taps used for drinking water
- Bins for food, packaging
- Zoomed in map of classroom/canteen/shop/staffroom

Outdoor:

- Any areas where food has been or will be planted
- Any areas where wild food is naturally growing (blackberries, nettles, hazel nuts etc)
- Any areas that might help food growing- pollinator friendly areas etc
- Any areas which provide food to wild animals
- Any litter spots

Sketching the Indoor section

- Sketch the shape of the school building.
- Work as individuals or in groups.
- Use the school fire escape plan or a picture from google maps to help
- Imagine you are looking down at the school from above and draw a “bird’s eye view”. Your map should show the school shape from above as if the roof has been cut off!
- This is probably not the final version so don’t worry about leaving space for the school grounds.

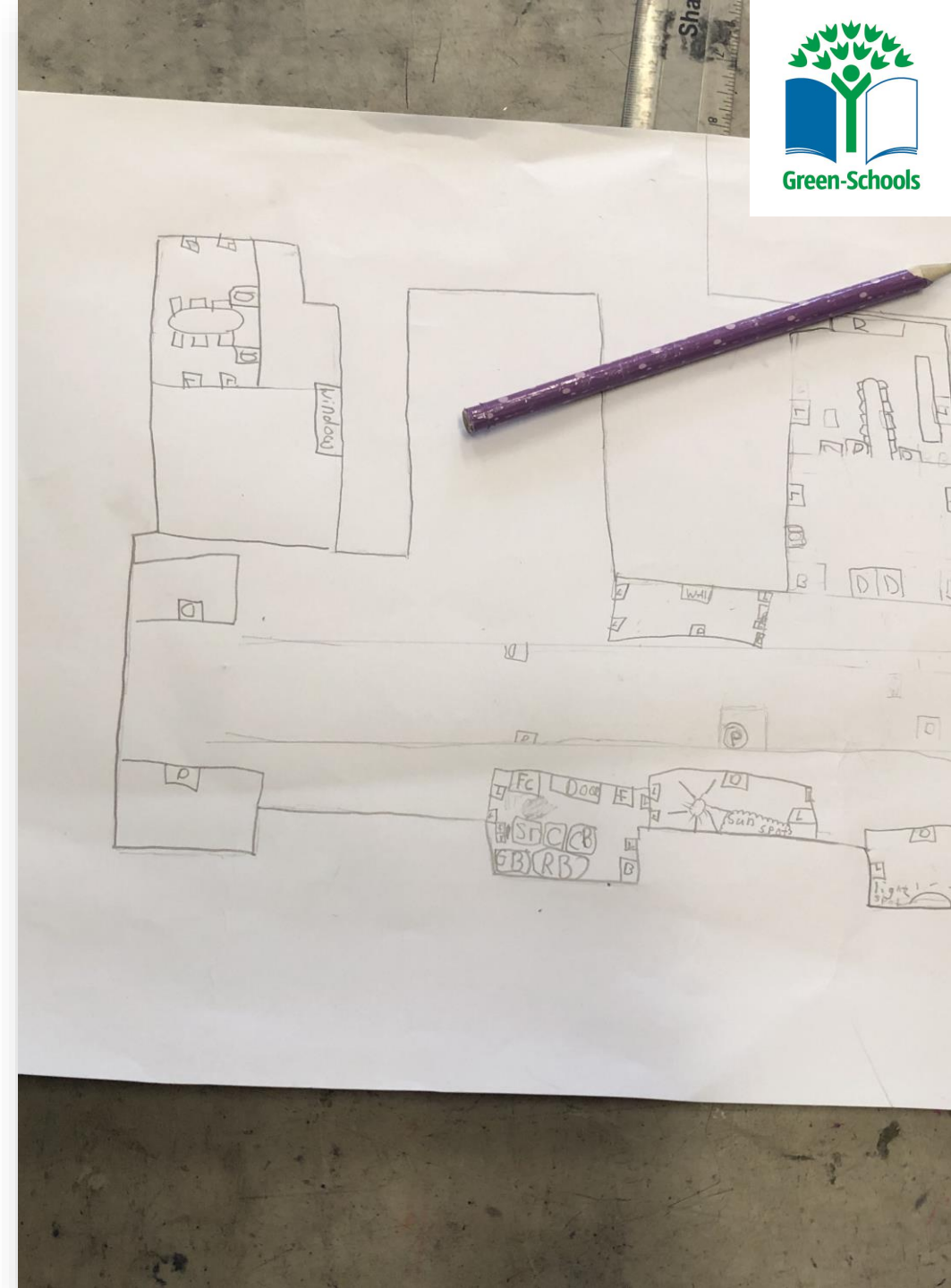

Completing your Indoor Mapping



Walk through your school and mark any areas connected with food on your sketch.



Be on the look out for litter from food, bins for food waste or packaging, water fountains, vending machines etc.



Choose one key area to focus on like a kitchen, canteen or even your classroom and mark in as many details as possible.



Look for sunny spots or windowsills that would be suitable for starting off growing food in pots.



If you get food delivered to your school mark the route it takes from the place it is stored to your classroom.



Bring a checklist of questions with you to assess the school environment. See Green Schools Sample checklist.

Outdoor Mapping



- Work in groups. Each group should use a fresh sheet of paper from the indoor map.
- Draw a small version of your school building in the middle of a page. It should only take up a tiny area so that you have room to mark everything you find.
- Choose a couple of key areas to mark first like the school yard and school gate so everyone is comfortable adding things to the correct position of the page
- Pay special attention to the areas you already grow or plan to grow food this year.
- Draw the position and shape of any beds, planters, pots etc. Note if they are in sun/shade.
- Use "GS Edible Plants in Schools" guide to search for wild food growing and GS sample checklist for sample survey.
- You can note and photograph any plants you are unsure of.

Top Tips

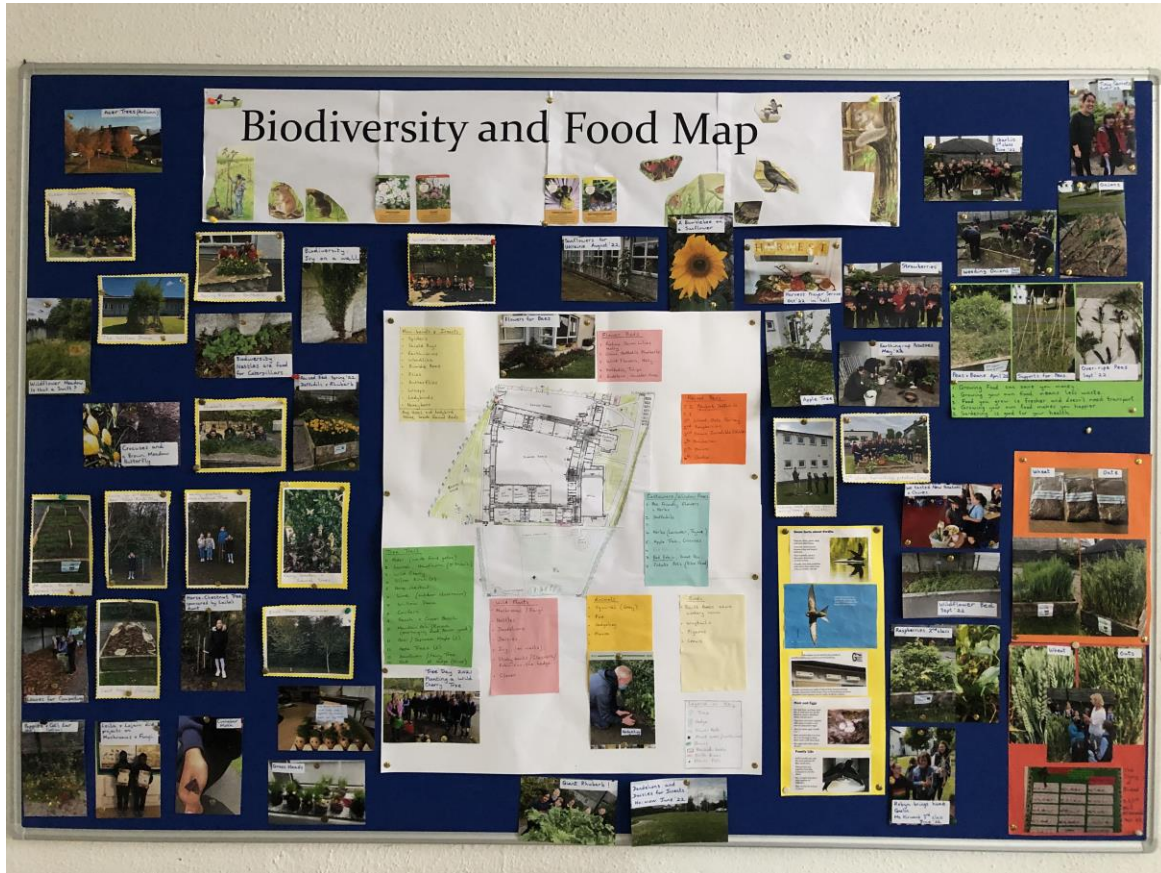

- Add in as much information as possible to your map as you go.
- Take photos and/or draw pictures or things you see.
- After your indoor and outdoor session choose the important information and make one large map
- Use codes and a legend to mark information.
- Display on your Green Schools Notice Board
- Keep track of what is planted or changed on map as the theme goes on. Add pictures of crops planted etc.